



11 Burt Street Mundingburra QLD

4  2  4 

Wake up to the river breezes and weekend adventures just footsteps from your door. Positioned across the road from Aplins Weir Rotary Park where location meets lifestyle. A ripper spot for shady arvo walks and family fun by the Ross River, with enclosed playgrounds, BBQ areas and open sports fields. The locals say it's the best fishing spot - perfect place to relax, play and soak up the outdoors - all year round.

This spacious and light-filled home presents an outstanding opportunity to secure a quality residence on a generous 675m² corner block. Designed for comfortable family living with excellent separation of space, the home combines warmth, functionality and lifestyle appeal.

Upstairs, striking timber floorboards and abundant natural light create an inviting atmosphere throughout the main living zones. The open-plan living and dining area flows seamlessly into the updated kitchen, featuring stone benchtops, breakfast bar seating and ample storage - ideal for both everyday living and entertaining.

Accommodation is generous, with three well-sized

Price : \$ 781,000
Land Size : 675 sqm
View : <https://www.kingsberry.com.au/sale/qld/townsville-district/mundingburra/residential/house/8618525>



Tammy Tyrrell
07 4772 2022
0412 534 704
tammy.tyrrell@tsvharcourts.com.au

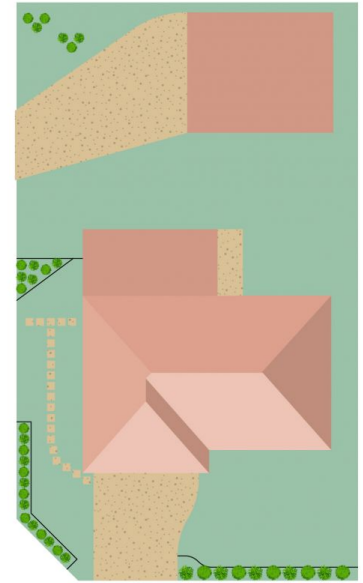

Scale in metres. Indicative only. Dimensions are approximate. All information contained herein is gathered from sources we believe to be reliable. However we cannot guarantee its accuracy and interested persons should rely on their own enquiries.

TOTAL AREA : 227 sq.m

11 Burt St, Mundingburra