



### 1 Doorey Street Railway Estate QLD

3  1  2 

Welcome to this beautifully renovated three-bedroom Queenslander, perfectly positioned in the highly sought-after suburb of Railway Estate. Blending timeless character with modern updates, this home is move-in ready and offers the perfect balance of lifestyle, comfort and convenience, just minutes from the CBD.

**Price** : \$ 680,000  
**Land Size** : 494 sqm  
**View** : <https://www.kingsberry.com.au/sale/qld/townsville-district/railway-estate/residential/house/8504443>

Step inside to polished timber floors, light-filled interiors and a brand-new kitchen and bathroom. Fully air-conditioned throughout, the home provides effortless year-round comfort, while freshly painted interiors and exteriors mean there's nothing left to do but unpack and enjoy.



Lily Staib  
07 4772 2022  
0434 358 875  
[lily.staib@tsvharcourts.com.au](mailto:lily.staib@tsvharcourts.com.au)

Outdoors, a private deck overlooks the fully irrigated yard, creating a serene setting for relaxing or entertaining with family and friends.

- Prime location in family friendly Railway Estate, close to schools, shops, parks and just a 5-minute drive to the CBD
- Three bedrooms, two with built-in robes - master includes a built-in desk
- Stylish new kitchen with electric oven and ample storage

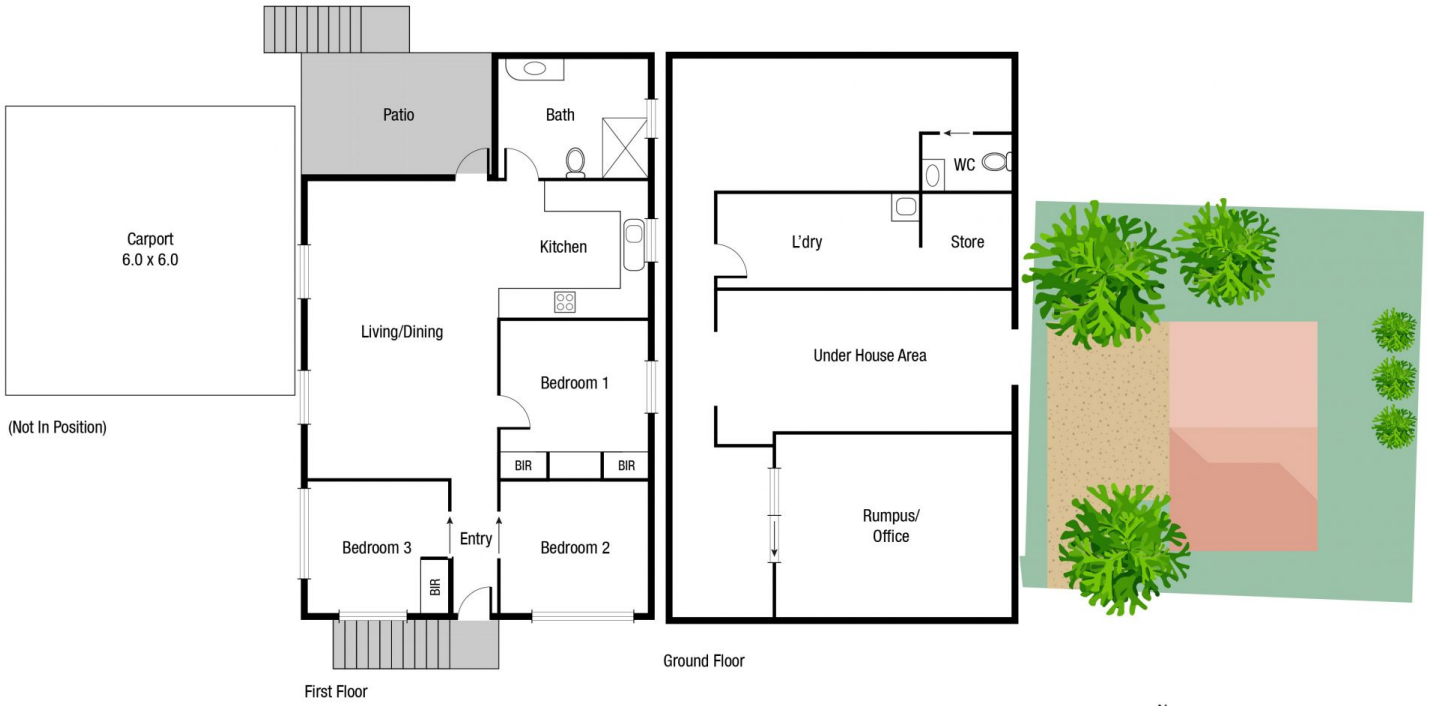

Scale in metres. Indicative only. Dimensions are approximate. All information contained herein is gathered from sources we believe to be reliable. However we cannot guarantee its accuracy and interested persons should rely on their own enquiries.

TOTAL AREA : 168 sq.m

## 1 Doorey Street, Railway Estate