



19 Partridge Street Mount Louisa QLD

3  1  5 

Welcome to 19 Partridge Street, Mount Louisa!

This freshly renovated, Solid Brick home offers everything you need for comfortable family living in one of the most sought-after areas of Mount Louisa. The property is vacant and ready for its new owners to move in.

Featuring 3 spacious bedrooms, with built-in wardrobes, and a stylish and functional main bathroom perfect for the entire family. The large kitchen is bathed in natural light and boasts plenty of bench space, along with new modern appliances, making it a dream for home cooks and entertainers alike.

Outside, the fully fenced yard provides ample space for children and pets to enjoy, with the added convenience of being just a short walk from the local dog park and Mount Louisa shops. The covered patio is the perfect spot for morning coffee or hosting barbecues with friends and family.

The home also includes a single lock-up garage for secure parking and extra storage. Situated on a corner block, you'll benefit from vehicle access from both Partridge Street and

Building Size : 127 sqm
Land Size : 624 sqm
View : <https://www.kingsberry.com.au/sale/qld/townsville-district/mount-louisa/residential/house/8153784>



Kimberley Sorbello
07 4772 2022
0459 351 825
kimberley.sorbello@tsvharcourts.com.au

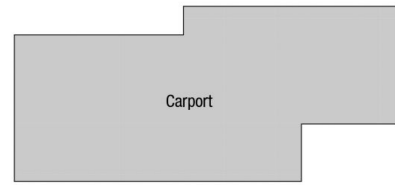
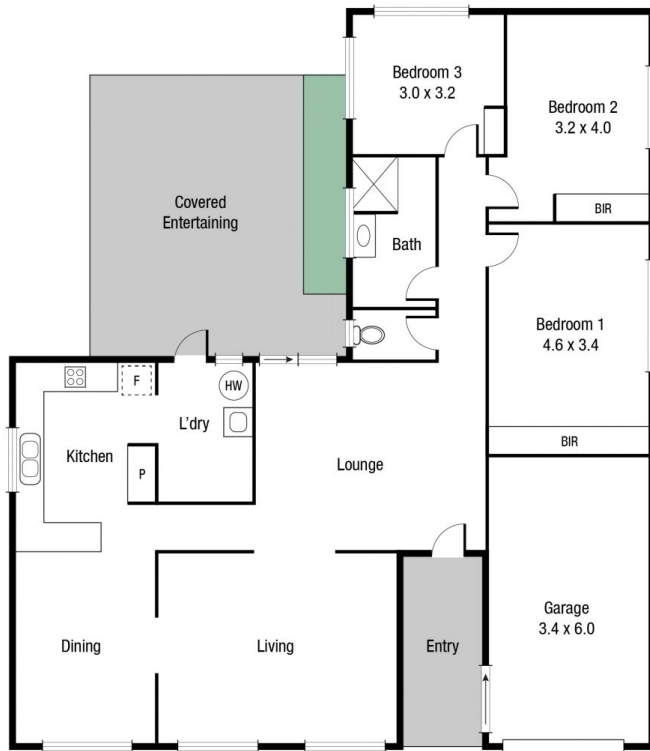

(Not In Position)

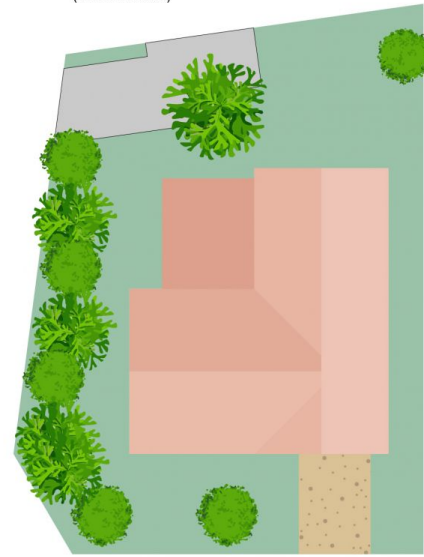

Scale in metres. Indicative only. Dimensions are approximate. All information contained herein is gathered from sources we believe to be reliable. However we cannot guarantee its accuracy and interested persons should rely on their own enquiries.

TOTAL AREA : 182.0 sq.m

19 Partridge St, Mount Louisa