



### 8 Ryrie Crescent Rasmussen QLD

3  1  2 

Picture a charming three-bedroom, one-bathroom home nestled in a peaceful suburban neighbourhood. As you approach, the exterior presents a welcoming facade with a two-bay carport and a path leads from the driveway to the front entrance, flanked by lush green lawns and flower beds bursting with colourful blooms.

**Price** : \$ 418,500  
**Land Size** : 668 sqm  
**View** : <https://www.kingsberry.com.au/sale/qld/townsville-district/rasmussen/residential/house/8074062>

Upon entering, you find yourself in a cozy foyer that opens up into the heart of the home. To the left, the living room awaits, boasting ample space for relaxation and entertainment. Large windows allow natural light to flood the room, enhancing the warm ambience created by the soft, neutral tones of the walls and plush carpeting underfoot.



Jayden Evans  
07 4772 2022  
0477 543 617  
[jayden.evans@tsvharcourts.com.au](mailto:jayden.evans@tsvharcourts.com.au)

Adjacent to the living room is the dining area, a separate space that comfortably accommodates a dining table set for family meals or gatherings with friends. This area is distinguished by its elegant light fixture above, casting a soft glow over dinners enjoyed here.

The kitchen, situated nearby, is efficiently designed with modern appliances seamlessly integrated into sleek

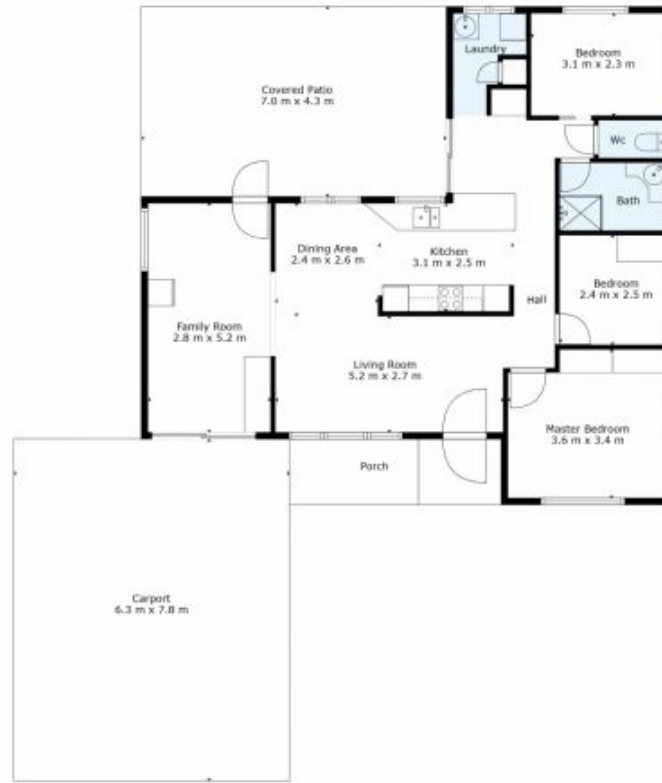

**TOTAL: 89 m<sup>2</sup>**  
 FLOOR 1: 89 m<sup>2</sup>  
 EXCLUDED AREAS: CARPORT: 49 m<sup>2</sup>, PORCH: 4 m<sup>2</sup>, COVERED PATIO: 30 m<sup>2</sup>,  
 "": 3 m<sup>2</sup>

Floor Plan Created By Cubicasa App. Measurements Deemed Highly Reliable But Not Guaranteed.