

Harcourts Kingsberry



23A Latchford Street Pimlico QLD

5 2 3

Located perfectly in the popular catchment of Pimlico you will find this radiant residence combining a comfortable high set layout with modern inclusions to provide a stress-free lifestyle.

Contemporary flair and style shines throughout this home spanning over two levels, where all living is essentially on the upper level while the lower level accommodates 2 bedrooms, second bathroom, and large rumpus room.

Upstairs you are greeted by timber floors, open plan living with separate living and dining plus a sweet sunroom providing plenty of space and light. The kitchen is tucked away and offers ample of cupboard and bench space.

The remaining 3 bedrooms are also located on this upper level alongside the refreshed main bathroom featuring shower and bath combination.

This extraordinary home offers multiple lifestyle options and space for the extended family. The lower level is perfect if

Price : Low \$500,000's
Land Size : 515 sqm
View : <https://www.kingsberry.com.au/sale/qld/townsville-district/pimlico/residential/house/7956771>



Tammy Tyrrell
07 4772 2022
0412 534 704
tammy.tyrrell@tsvharcourts.com.au

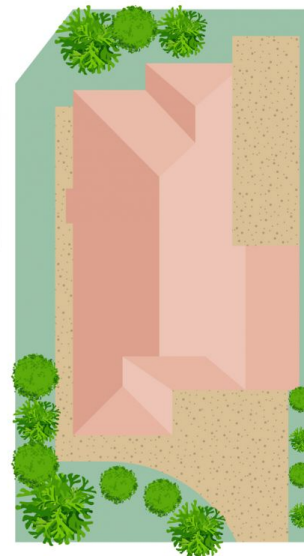
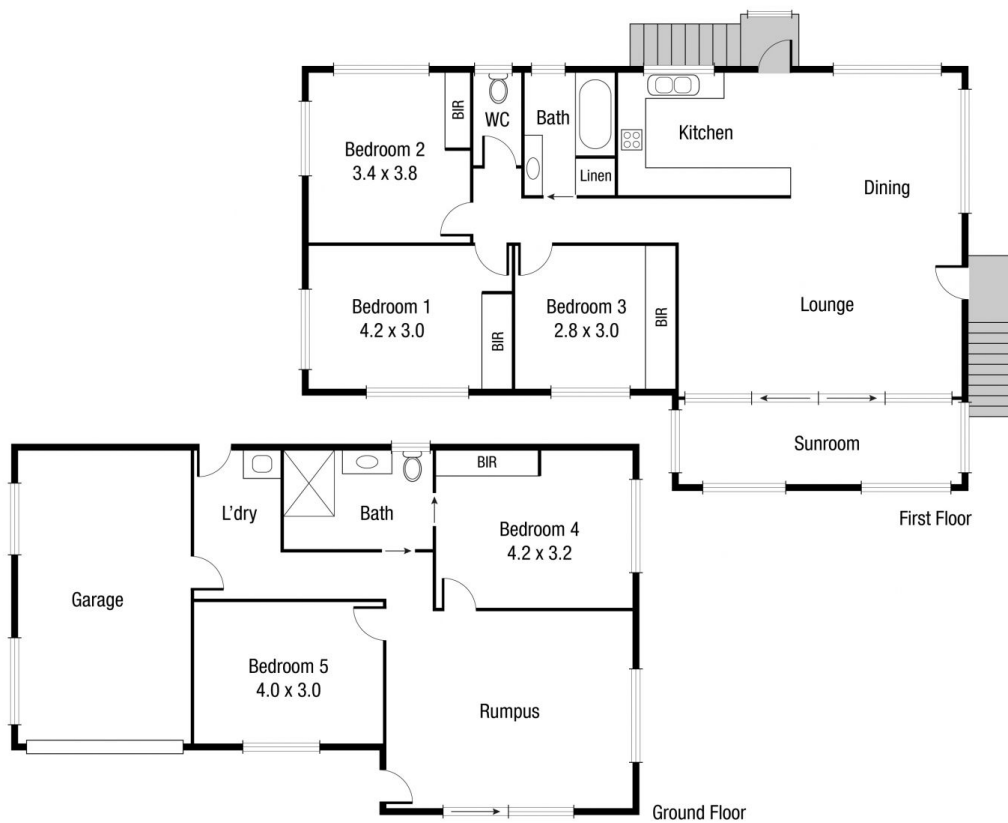

Scale in metres. Indicative only. Dimensions are approximate. All information contained herein is gathered from sources we believe to be reliable. However we cannot guarantee its accuracy and interested persons should rely on their own enquiries.

TOTAL AREA : 190.0 sq.m

23A Latchford St, Pimlico