

Harcourts Kingsberry



6/6 Mary Street West End QLD

3 1 1

Indulge in the epitome of refined living in this 3-bedroom townhouse, just 300 meters from the soon to be completed West State Private hospital. Every inch of this residence has been meticulously renovated, with the owner sparing no expense to create a truly exceptional home. Revel in the luxury of a walk-in robe, 2 toilets, and a stylish bathroom within the spacious 138m2 layout.

Located in the heart of the action, this townhouse offers low body corporate fees and is strategically placed 2 kilometers from the vibrant CBD and 4 kilometers from the picturesque Strand. Unwind in your private courtyard or on the top-level veranda offering picturesque views of Castle Hill, secured by features like security screens and deadlocks.

Convenience is key, with undercover parking and ample visitors' spaces. Proximity to schools, public transport at the corner, and a major shopping center just 2 kilometers away make this property an ideal blend of modern living and accessibility.

Whether you seek the perfect home or a savvy investment, this townhouse beckons you to a lifestyle where comfort and convenience converge. Act now and experience the meticulous craftsmanship where no expense has been spared.

Price : \$ 370,000

View : <https://www.kingsberry.com.au/sale/qld/townsville-district/west-end/residential/townhouse/7881096>



Loretta Fabbro

07 4772 2022

0408 997 766

loretta.fabbro@tsvharcourts.com.au

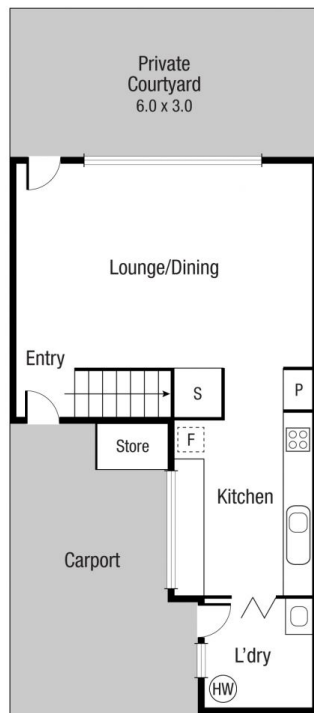

Ground Floor

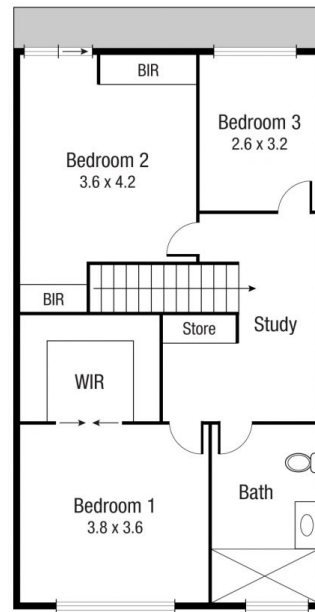

First Floor

Scale in metres. Indicative only. Dimensions are approximate. All information contained herein is gathered from sources we believe to be reliable. However we cannot guarantee its accuracy and interested persons should rely on their own enquiries.

TOTAL AREA : 156.0 sq.m

5/6 Mary St, West End