

Harcourts Kingsberry



66 Sanctuary Drive Idalia QLD

5 3 3

Warm and welcoming with stunning street appeal this home is sure to impress. Thoughtfully designed with every detail of easy modern living in mind, this abode is truly special and will provide your family with many memorable moments - you will never want to leave!!

Upon arrival, you are instantly captivated by its exquisite presence and are sure to fall in love at the front gate.

Proudly built with premium and state-of-the-art, inclusions, every space is captivating. Spectacularly spanning over 3 levels this residence is astonishing. The luxurious upper level brings to life a stunning sophisticated master bedroom showcasing larger than life windows that exposes the outdoor with endless river views. The fashionable dresser has been designed for the fussiest featuring beauty bar, dual basins, walk in robe with separate sizeable shower and toilet.

The second level is where the home comes to life,

Price : \$ 1,260,000
Land Size : 1001 sqm
View : <https://www.kingsberry.com.au/sale/qld/townsville-district/idalia/residential/house/7811043>



Tammy Tyrrell
07 4772 2022
0412 534 704
tammy.tyrrell@tsvharcourts.com.au

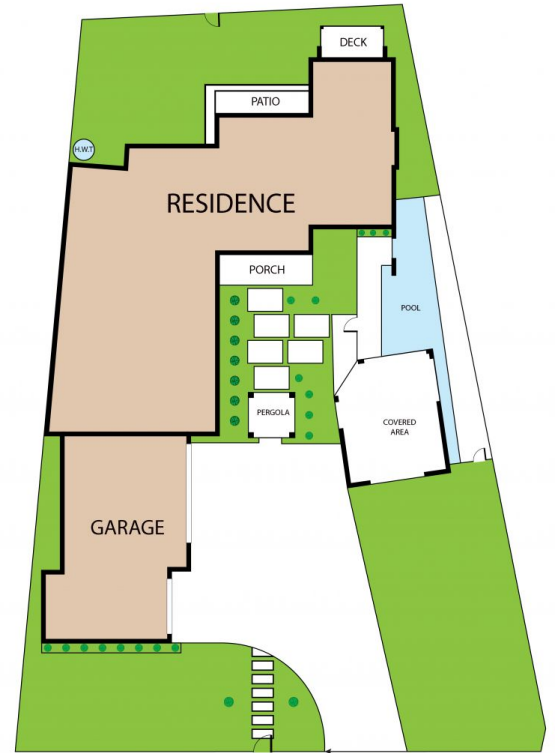

66 Sanctuary Drive, Idalia 4811

TOTAL APPROX. FLOOR AREA 363 SQ.M

Whilst every attempt has been made to ensure the accuracy of the floor plan contained here, measurements of doors, windows, rooms and any other items are approximate and no responsibility is taken for any error, omission, or misstatement. This plan is for illustrative purposes only and should be used as such by any prospective purchaser.