

Harcourts Kingsberry



146 Klewarra Boulevard Douglas QLD

4 2 2

Nestled within a sought-after community, this double-storey family home offers a unique blend of space, comfort, and style. Situated on a 627sqm corner allotment, with an elevated vantage point, the residence enjoys panoramic views over toward the CBD and The Pinnacles whilst the abundance of breeze will ensure a pleasant ambience year-round.

The residence is under two years old and offers a contemporary floor plan coupled with light tones and generous internal proportions. The property is located minutes' Drive to the main economic drivers of Townsville being the Townsville University Hospital, James Cook University and Lavarack Barracks.

Features:

- Master bedroom enjoys city views and complete with

Price : \$ 670,000
Land Size : 627 sqm
View : <https://www.kingsberry.com.au/sale/qld/townsville-district/douglas/residential/house/7806633>



Adrian Raiteri
07 4772 2022
0427 673 612
adrian.raiteri@tsvharcourts.com.au



Sam Musumeci
07 4772 2022
0412 469 104
sam.m@tsvharcourts.com.au

<https://www.kingsberry.com.au>

210 Charters Towers Road Hermit Park QLD
07 47 722 022

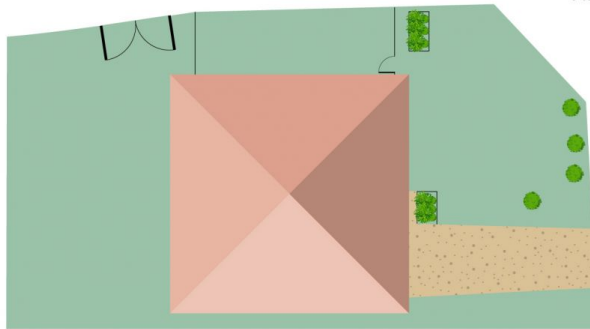

Scale in metres. Indicative only. Dimensions are approximate. All information contained herein is gathered from sources we believe to be reliable. However we cannot guarantee its accuracy and interested persons should rely on their own enquiries.

TOTAL AREA : 233.84 sq.m

146 Klewarra Bvd, Douglas