

# Harcourts Kingsberry

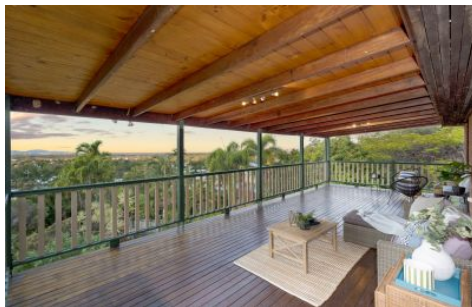

## 10 Dahl Crescent Wulguru QLD

3  1  2 

Dazzling by day Magical by night. This haven is designed specifically to take advantage of the stunning views and breezes. Surrounded by beautiful landscape and well-established gardens - this is hillside living at its best. Here you can holiday from home every day!!

Warm and welcoming over two levels this adorable abode provides versatile living with 2 of the bedrooms and bathroom positioned on the top floor. The master bedroom offers its own Juliette balcony ideal for a nightcap or early morning cuppa.

The lower level is where the home comes to life showcasing a spectacular generous deck overlooking the city views and stunning inground pool. There is also a 3rd bedroom on this level ideal for guests or home office. The tucked away kitchen features stone bench tops and gas cooking. The open plan living highlights plenty of light and breezes delivering a holiday ambiance - it truly is a special

**Price** : \$ 500,000  
**Land Size** : 1032 sqm  
**View** : <https://www.kingsberry.com.au/sale/qld/townsville-district/wulguru/residential/house/7789825>



Tammy Tyrrell  
07 4772 2022  
0412 534 704  
[tammy.tyrrell@tsvharcourts.com.au](mailto:tammy.tyrrell@tsvharcourts.com.au)

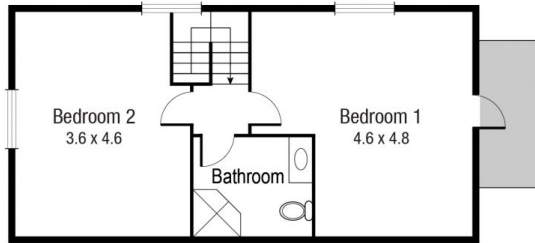

First Floor

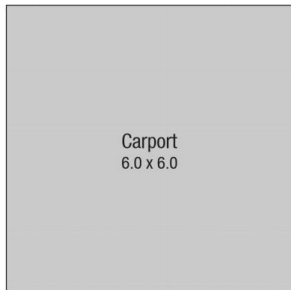

(Not In Position)

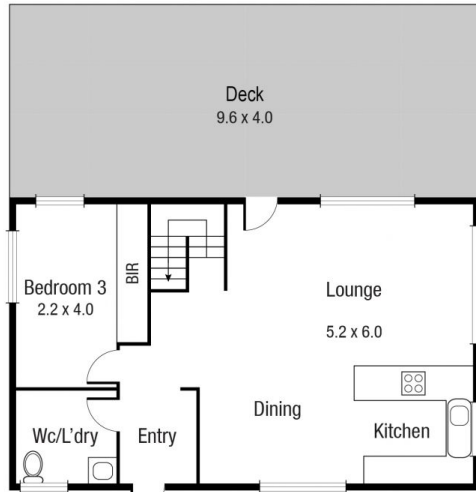

Ground Floor

Under house storage  
←

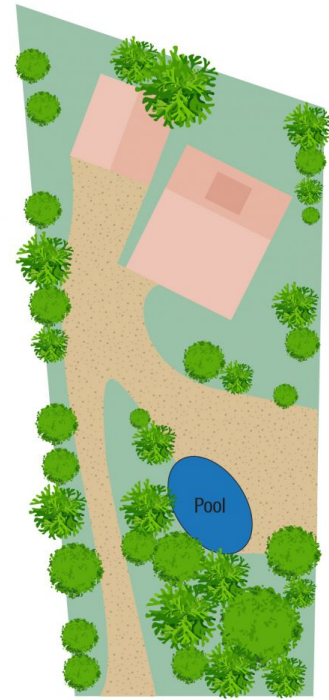

Scale in metres. Indicative only. Dimensions are approximate. All information contained herein is gathered from sources we believe to be reliable. However we cannot guarantee its accuracy and interested persons should rely on their own enquiries.

TOTAL AREA : 139.4 sq.m

10 Dahl Cr, Wulguru