



20 Masuda Street Annandale QLD

3 1 2

"Are you looking for the perfect family home in the desirable suburb of Annandale? Look no further than this 3-bedroom beauty boasting 2 living areas.

The backyard is a blank canvas just waiting for you to add your own touch - imagine a sparkling pool, a handy shed or veggie garden. Entertain guests on the large rear patio, perfect for weekend barbeques or just relaxing with family and friends.

The front of the property boasts a large, secure fence providing privacy and peace of mind. Take in the stunning views of Mt Stuart from the comfort of your own front porch. This home has been freshly rendered, giving it a modern and stylish finish. The internal laundry adds convenience to your day-to-day routine, while the large windows and glass doors allow plenty of natural light to flood the living spaces. The kitchen offers ample cupboard and bench space, and the separate dining area means there's plenty of room for everyone. With two living areas, there's no shortage of space for the whole family to enjoy.

This home is a must-see for anyone searching for the perfect family home in Annandale.

Annandale is a conveniently located, popular suburb surrounded by major shopping centres, Townsville

Price : \$ 387,500
Land Size : 670 sqm
View : <https://www.kingsberry.com.au/sale/qld/townsville-district/annandale/residential/house/7546309>



Tammy Tyrrell
07 4772 2022
0412 534 704
tammy.tyrrell@tsvharcourts.com.au

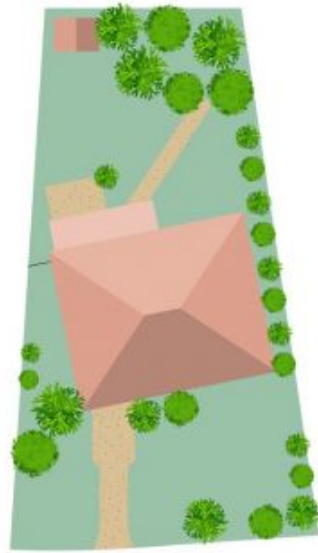
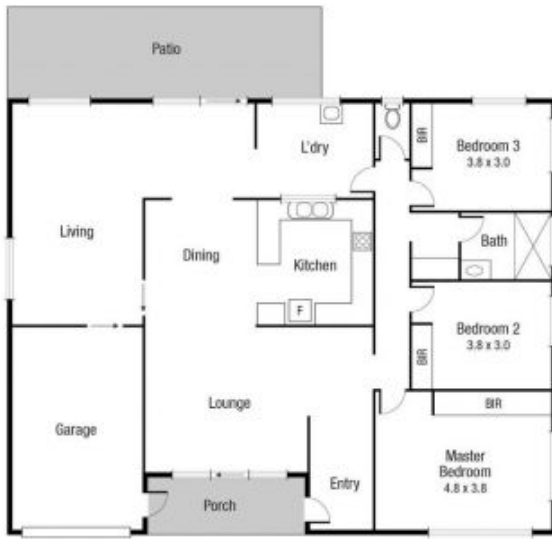

Scale in metres. Indicative only. Dimensions are approximate. All information contained herein is gathered from sources we believe to be reliable. However we cannot guarantee its accuracy and interested persons should rely on their own enquiries.

TOTAL AREA : 191.2 sq.m

20 Masuda