



35 Riley Circuit Kirwan QLD

4 2 6

Introducing a magnificent family home that offers the ultimate lifestyle with all the amenities you could possibly need. This stunning four-bedroom, two-bathroom home is a spacious retreat offering privacy and luxury in a desirable location.

Upon entry, you will be welcomed by the light-filled and spacious living area that is perfect for relaxed family living. The first living area features large windows that bathe the room in natural light, while the second living area is more intimate with direct access to the outdoor entertaining space, perfect for hosting events.

A separate dining space provides a designated area for meal times, while the well-appointed kitchen with modern appliances, a walk-in pantry, and ample bench space is a chef's dream. The kitchen seamlessly flows to the outdoor entertaining area, providing the perfect space to entertain family and friends.

Step outside to your expansive undercover outdoor entertaining space, complete with a beautiful plunge pool that is perfect for those hot summer days. The outdoor area

Price : \$ 534,000
Land Size : 803 sqm
View : <https://www.kingsberry.com.au/sale/qld/townsville-district/kirwan/residential/house/7532426>



Jayden Evans
07 4772 2022
0477 543 617
jayden.evans@tsvharcourts.com.au

35 Riley Circuit, Kirwan

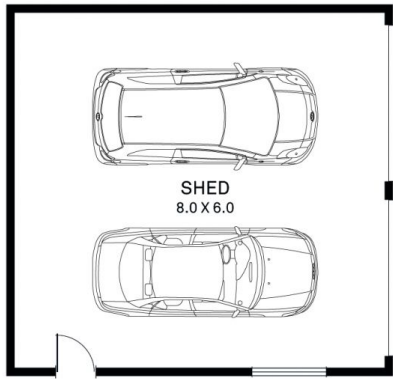

(NOT IN POSITION)

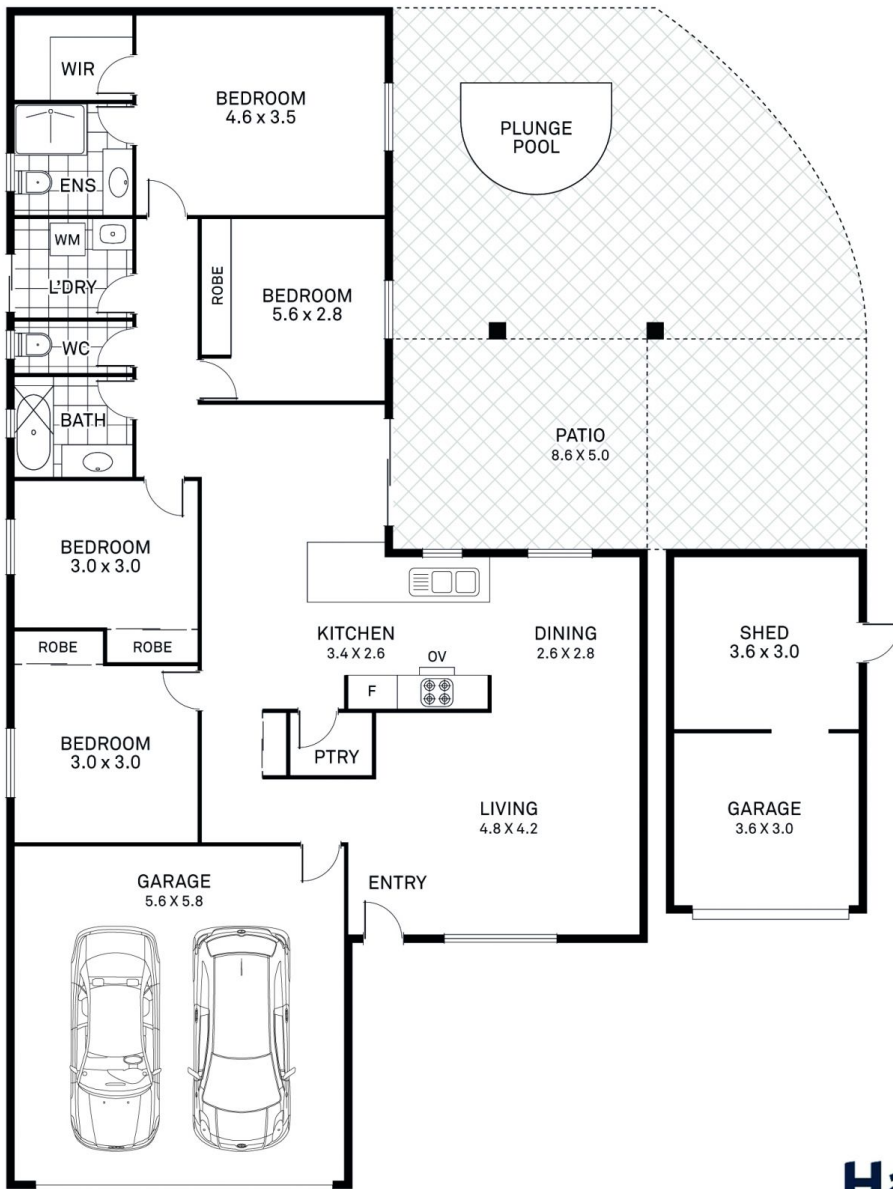

AREA (M ²)	
GARAGE/SHED	- 102
LIVING	- 119.9
PATIO	- 43
TOTAL	- 264.9