

# Harcourts Kingsberry



## 4/1 Hodel Street Rosslea QLD

2 2 1

Tucked away in a quiet complex on the banks of Ross River, this humble low maintenance two-bedroom apartment is light and bright and is perfectly located minutes to schools and shops and just around the corner from the Townsville Golf Course. Whether you are looking for a low maintenance investment to add to the portfolio, a modest first home at an affordable price or a weekender to enjoy when your in town, then this property is perfect for you!

Property offers but is not limited to:

- Two spacious bedrooms with built in robes and quality split system air-conditioning
- Master bedroom complete with ensuite bathroom and balcony overlooking Ross River
- Main bathroom is large in size and features shower, toilet and vanity and also houses a generous laundry and linen

**Price** : \$ 180,000

**View** : <https://www.kingsberry.com.au/sale/qld/townsville-e-district/rosslea/residential/unit/7145829>



**Adrian Raiteri**  
**07 4772 2022**

<https://www.kingsberry.com.au>

210 Charters Towers Road Hermit Park QLD  
07 47 722 022

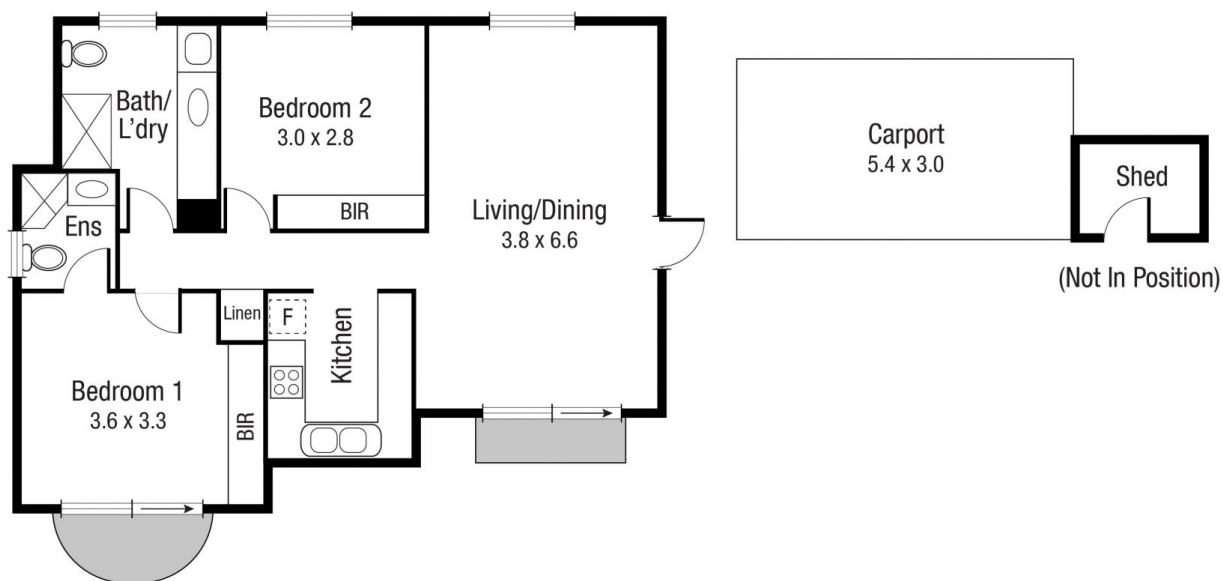

Scale in metres. Indicative only. Dimensions are approximate. All information contained herein is gathered from sources we believe to be reliable. However we cannot guarantee its accuracy and interested persons should rely on their own enquiries.

**TOTAL AREA : 104.88 sq.m**

**4/1 Hodel St**