



11 Dahl Crescent WULGURU QLD

4  2  2 

Solid-built, spacious and functional, this great family home is situated on an elevated 1,027m² block in the hills of Wulguru. There is so much to love about this home from the beautiful cathedral ceilings, swimming pool to the cool breezes and the twinkling lights at night.

On offer are three bedrooms and a study, two bathrooms, a multiple use 4th bedroom or media room all spread throughout the multi-storey floorplan with views. The entry level offers the expansive media room which can be utilised as a 4th bedroom. Opposite is a conveniently placed study and there is also lockup accommodation for two cars.

Stairs lead upwards to the top floor which boasts three bedrooms designed to enjoy both the breezes and views over Townsville. The bathroom here features a shower and separate bathtub for younger families.

The lower level has a galley-style kitchen with plenty of bench and storage space and views over the pool and alfresco area. To the right of the kitchen is a dining room with sliding doors and to the left is the second living area with sliding doors which lead out to the covered poolside

Land Size : 1027 sqm

View : <https://www.kingsberry.com.au/sale/qld/townsville-district/wulguru/residential/house/6043998>



Michael Martini

07 4772 2022

0418 731 677

michael.martini@tsvharcourts.com.au



Middle Floor

Lower Floor

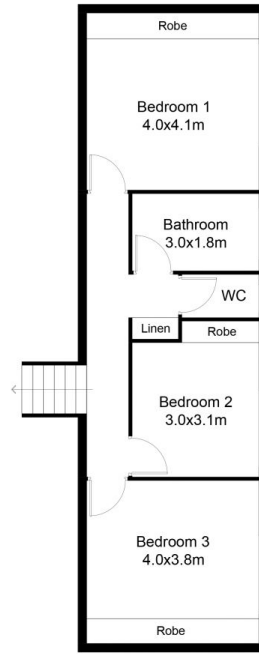

Upper Floor

11 Dahl Crescent, Wulguru