

Harcourts Kingsberry



32 Ventura Court KIRWAN QLD

4 2 4

This versatile home is positioned on a fully fenced 746m2 allotment, offering spectacular views of Castle Hill, Mount Stuart and Mount Louisa.

Price : \$ 300,000

View : <https://www.kingsberry.com.au/sale/qld/townsville-e-district/kirwan/residential/house/4976893>

You will enjoy the company of a variety of native wildlife enjoying the back to nature back yard. Relish in the flow through all year round breezes while relaxing on the rear deck soaking in the superb sunset.

This home has been reinvented to accommodate the growing family. Appointed with quality fixture and fittings plus hardwood polished timber floors throughout.

Conveniently located in a sought after position within a quiet cul de sac, off street parking with two vehicle secure storage underneath the home and driveway parking. A skillion off the side of the property, which allows protection



Stephanie Turnbull

07 4772 2022

0459 528 095

stephanie.turnbull@tsvharcourts.com.au

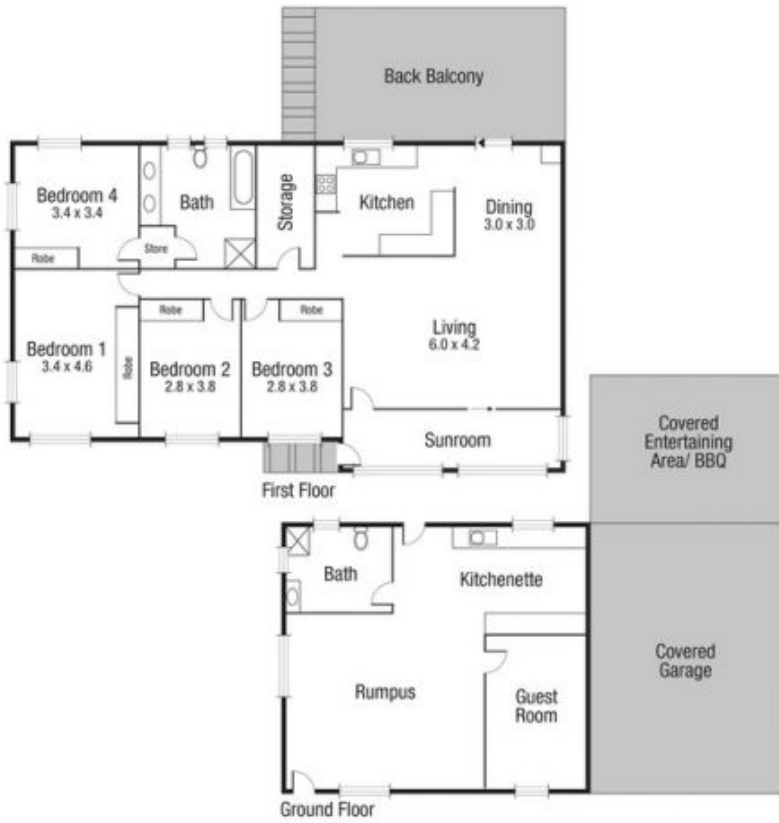

Scale in metres. Indicative only. Dimensions are approximate. All information contained herein is gathered from sources we believe to be reliable. However we cannot guarantee its accuracy and interested persons should rely on their own enquiries.

TOTAL : 276.1 sq.m

32 Ventura Kirwan